

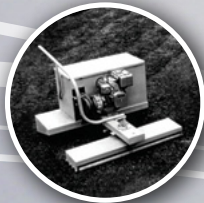
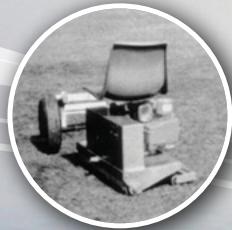

TRU-TURF

Product Catalogue

**1942****1960****1978****1986****1996****2005****2008****2013**

A Proud History of Innovation

Tru-Turf are industry leaders in the design and manufacture of Golf Greens and Sports Turf Rollers and have a proud history of innovation dating back to the early 1970's.

Unlike many of their competitors, Tru-Turf's patented technologies produce fast, true greens through design, not weight.

Tru-Turf rollers are being used on the world's most prestigious courses and several Tru-Turf models are officially licensed products of the PGA TOUR.

TIMELINE

- 1942** - 36" diameter hand roller
- 1960** - First ride on roller with 2.5" rollers
- 1978** - First golf greens roller
- 1986** - First tri-roller 2.5" rollers GR39 series
- 2005** - Roller trailer re-engineered
- 2006** - First brush option introduced RS48
- 2008** - First in world, flexible drive roller
- 2008** - 1st electric tri-roller R52-ELT
- 2009** - LED light option introduced
- 2009** - Jockey wheel leveller for R52-ELT
- 2010** - Double sealed rollers introduced
- 2011** - Drum style park brake introduced
- 2012** - First Multi Wheel pin spiker introduced
- 2012** - First smoothing roller brushes fitted
- 2013** - Operator presence system introduced
- 2013** - First AC powered greens roller R52-ELTac



Golf Greens

Rollers

Tru-Turf - The original turf rolling company are proud to present their latest series of greens rollers. Tru-Turf golf greens rollers are renowned for their ability to follow contoured greens with even ground pressure, utilizing design, not weight to produce a Tru-Turf surface.

Tru-Turf's gasoline golf greens rollers have a power-train designed to handle the toughest operating conditions, utilizing a Honda 6.5HP OHV engine with lighting coil, coupled to a heavy duty Eaton 11 hydrostatic transmission, stainless steel oil reservoir and heavy duty, low oil pressure steel lines.

The stealthy R52-ELTac electric golf greens roller utilizes a powerful electric motor to silently roll up to 25° plus greens on a single charge, while effortlessly maintaining its rolling speed up or down hills.

All Tru-Turf Greens Rollers have a rubber coated, non-stick drive roller, providing the traction needed for the most challenging of course designs.



Built in trailer

The patented tri-roller smoothing heads are fitted with heavy duty smoothing rollers that are double sealed and fitted with quality ball bearings for longer life. A balanced roller produces an evenly rolled turf surface and it's no coincidence just how well balanced Tru-Turf rollers are. The designed-in low centre of gravity ensures roller stability and operator safety (see centre of gravity diagram below).

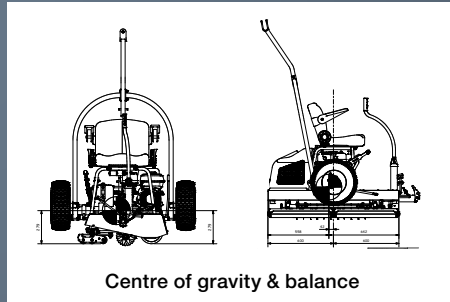

Centre of gravity & balance

The unique and easily operated, built in trailer includes heavy duty axles and trailer arms. When combined with the rugged but lightweight features of Tru-Turf greens rollers, they are ready to take on the world's most demanding courses and competitors. Tru-Turf greens rollers are used extensively on the PGA TOUR, Champions TOUR and Nationwide TOUR events.

** All claims with regard to performance are dependent on many variables, some of which are, course conditions, equipment setup & maintenance, operator proficiency etc.*



RB48-11A

Built from the ground up for performance, safety and durability the RB48-11A Golf Greens Roller is Tru-Turf's workhorse. Its dual rolling heads utilizes Tru-Turf's patented offset rollers to roll a 48" (1200mm) swath in a single pass.

Steering is light and easy, providing smooth operation on the most challenging of greens.

The RB48-11A is ideal for those on a tight budget and don't want to compromise on quality.



R52-11TC

Tru-Turf's premier gasoline roller boasts patented triple smoothing heads and a contour following flexible drive roller, leaving a true, smooth path, 52" (1320mm) wide on the most contoured greens without leaving gaps or line crease marks.

The industry leading R52-11TC is fast, efficient and reliable, so much so it is currently being used on PGA TOUR, Champions Tour and Nationwide Tour events throughout U.S.A. and Canada.



RS48-11D

The versatile RS48-11D incorporates all the industry leading features of the RB48-11A. In addition, productivity is increased with 12v LED lights for early morning or late night runs. A slicer is also fitted as standard to help eliminate dry spots, remove excess water from greens and increases oxygen levels in the soil.

Work load can also be simplified with optional sweeper and multi pin spiker attachments.



R52-ELTac

The stealthy all electric R52-ELTac Triplex Golf Greens Roller boasts a state of the art 48volt, fully programmable drive system that has ample power and agility to roll the most challenging golf greens without leaving gaps or line crease marks.

Unlike its competitors, the R52-ELTac, with its ground breaking efficiency is capable of rolling up to 25 plus greens quickly and quietly on a single charge.



R52-11TC

Tri-head Triplex Greens Roller

SPECIFICATIONS	RB48-11A	RS48-11D	R52-11TC	R52-ELTAc
Engine - Type Horsepower Lighting coils		Honda - Gasoline 6.5 hp (4.85 kW) Yes		48 Volt Electric 18 hp (13.5 kW) N/A
Transmission - Manufacturer Type		Eaton Hydrostatic 11		Falk Ultramite DBL reduction helical
Oil Capacity - Engine Transmission		1.05qts (1L) + Filter 6qts (6.84L) + Filter		N/A Sealed
Cooling		8 blade hydro transmission cooling fan		N/A
Drivetrain		1/2" duplex chain, self adjusting ISO 08B2		Toothed belt
Drive Roller		Rubber coated, non stick.	Rubber coated, non stick. Flexible, contour following.	
Direction Control		Foot pedals		Switch - fingertip
Speed Control		Foot pedals		Foot pedal
Operating Speed		0 - 9 mph (0 - 15 km/h)		
Steering		Joystick - Light load, directly connected to smoothing heads.		
Vibration		Reduced through engine isolation mounts.		N/A
Seat		Premium UV protected, with adjustable arm rests.		
Trailer		Integrated, heavy duty. Quick & easy transition from transport to rolling position.		
Ground Pressure (Footprint)		3.5 psi (24 kPa)	3.3 psi (22.8 kPa)	3.8 psi (26 kPa)
Smoothing Heads		2 x 24" (600mm)		3 x 18" (460mm)
Rolling Width		48" (1200mm)		52" (1320mm)
Lights	Optional	2x12v LED	Optional	2x48v LED
Weight - Operating	551lb. (250kg)	624lb. (283kg)	772lb. (350kg)	1078lb. (490kg)
Tires - Trailer		16 x 6.50 x 8		18 x 6.50 x 8
Slicer - Spring steel	Optional	Standard	N/A	N/A
Start / Stop		Switch & recoil		Key / Electric
Brake		Hand & drum		Regenerative
OPS Safety Switch		Seat activated		15 second delay
Optional Equipment	Slicer, brush & spiker	Sweeper, Spiker	N/A	N/A
Warranty		2 years - Limited manufacturers warranty		

Greens Mower

Tote

The MT5000 Tote allows you to easily secure and transport your valuable greens mower safely. Its unique automotive style independent suspension absorbs ground imperfections that can react with the mower during transportation. This reduces maintenance issues by allowing your mower to maintain its finely set reel to bedknife and cutting height adjustments.

Ergonomically designed for operator safety, Tru-Turf's distinctive tote requires no lifting or dragging of the mower up ramps into a trailer. Your mower is quickly secured using a strap and locking pins.

This universal design suits all popular mowers 18" to 26" including flex head models. With this unique design cleaning, back lapping, setting reel to bedknife and adjusting the height of cut can all be done while stowed on the Tote.

Totes are easily stored. Multiple Totes with mowers stowed can be easily nested together to save storage space.

Specifications	
Tires	16 x 6.50 x 8 turf tire
Width	4'9" (1500mm)
Max capacity	440lb. (200kg)
Material	H.D. R.H.S. Steel

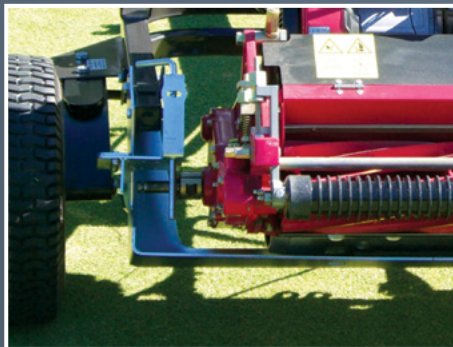

Axle locking pin



No reel contact

Easily attaches to your John Deere, Jacobsen, Baroness or Toro Mower.



John Deere

The MT5000 for John Deere mowers;

- Suits model sizes 18"-26".
- 180 B/C, 220 B/C, 260 B/C, flex head and most earlier models.
- Wide wheel base ensures safe towing.
- A low centre of gravity for increased stability.
- Mowers can be easily loaded and unloaded.



Jacobsen

The MT5000 for Jacobsen mowers;

- Suits model sizes 18"-26".
- PGM 22", Eclipse 100 series, Greens King 500 series, flex head and most earlier models.
- Wide wheel base ensures safe towing.
- A low centre of gravity for increased stability.
- Mowers can be easily loaded and unloaded.



Baroness

The MT5000 for Baroness mowers;

- Suits model sizes 18"-26".
- LM56 - 22", LM66 - 26", LM45 - 18".
- Wide wheel base ensures safe towing.
- A low centre of gravity for increased stability.
- Mowers can be easily loaded and unloaded.



Toro

The MT5000 for Toro mowers;

- Suits model sizes 18"-26".
- Greenmaster Flex 18"-21" , Greenmaster 1000, Greenmaster 1600 and most earlier models
- Wide wheel base ensures safe towing.
- A low centre of gravity for increased stability.
- Mowers can be easily loaded and unloaded.

Golf and Sports Turf

Roller

The SR72 Golf & Sports Turf Roller has a 76" (1900mm) rolling width. Attached to a tractor for towing, it utilizes the 3PL (three point linkage) system (cat 2 or 3) to raise, lower and transport.

The SR72 Golf & Sports Turf "Roll n Spike" Roller is designed to true golf and sports turf surfaces which, in turn, improves turf health, playability and helps to reduce sports related injuries. It also achieves excellent results on newly laid turf.

Tru-Turf's patented triple offset smoothing head roller configuration allows this engineered product to smooth the turf by design, not by weight.

Two operations can be performed simultaneously by engaging the spiker while rolling – "Roll n Spike".

Spiking assists with oxygen and moisture replenishment, resulting in healthier turf. It also helps break surface hardness, assisting the roller in truing the surface more rapidly.

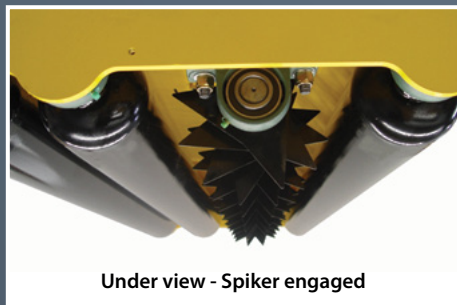

Under view - Spiker engaged

Optional bar weights can be added to the SR72 as necessary to suit rolling conditions.

Note: Seek advice from your tractor supplier as to the suitability of your current tractor or with regard to purchasing a tractor that meets or exceeds the requirements of safely lifting, transporting and operating the SR72.

Unit is not speed limited - local conditions control working speed.

Specifications

Linkage	3 point setup, cat 2 or 3
Smoothing Rollers	3 offset
Roller Diameter	6½" (165mm)
Spikers	5/32" (4mm) spring steel, set 1½" (40mm) apart
Spiker Depth	1" (25mm), 1½" (38mm) or 2¼" (55mm)
Min. Tractor Size	Must be suitable to lift roller & additional weights if fitted.
Speed	Low or High
Ground pressure	Low
Swath	6' 4" (1900mm)
Weight	1650lb. (750kgs)
Options	Additional Weights



Ready for Towing



SR72

Whatever your game, reduce player injuries and increase turf quality.

Golf Greens

Triplex

Easily attaches to your triplex greens mower to give you cutting, rolling and slicing in one machine.

Designed to attach to a triplex greens mower and driven in the traditional direction, these units feature Tru-Turf's proven greens rolling technology, incorporating both the triple offset rollers and engageable slicing blades.

Slicing blades can be easily engaged from no contact to half depth ($\frac{3}{4}$ " [20mm]) or full depth ($1\frac{1}{4}$ " [30mm]) settings.

Greens can be perimeter rolled, or rolled in any direction that mowing can be performed.

Tru-Turf triplex heads are easily mounted to John Deere 2500 mowers, Jacobsen 4, 5, and 6 series mowers and the Toro 3000, 3250 series mowers giving you a versatile rolling, mowing and slicing machine.

Triplex heads for the latest brand mowers are currently under development.

Specifications

Smoothing Rollers	3 offset
Roller Diameter	2 $\frac{3}{8}$ " (60mm)
Swath	66" (1685mm)
Spikers	13 x 8 points to a depth of 20mm ($\frac{3}{4}$ ") or 30mm ($1\frac{1}{4}$ ")
Weight	130lb. (58kgs)



John Deere 2500



Toro 3000-3250 Series



Jake 4,5 & 6 Series



Under body

TR66

The triplex option gives you cutting, rolling and slicing in one machine.

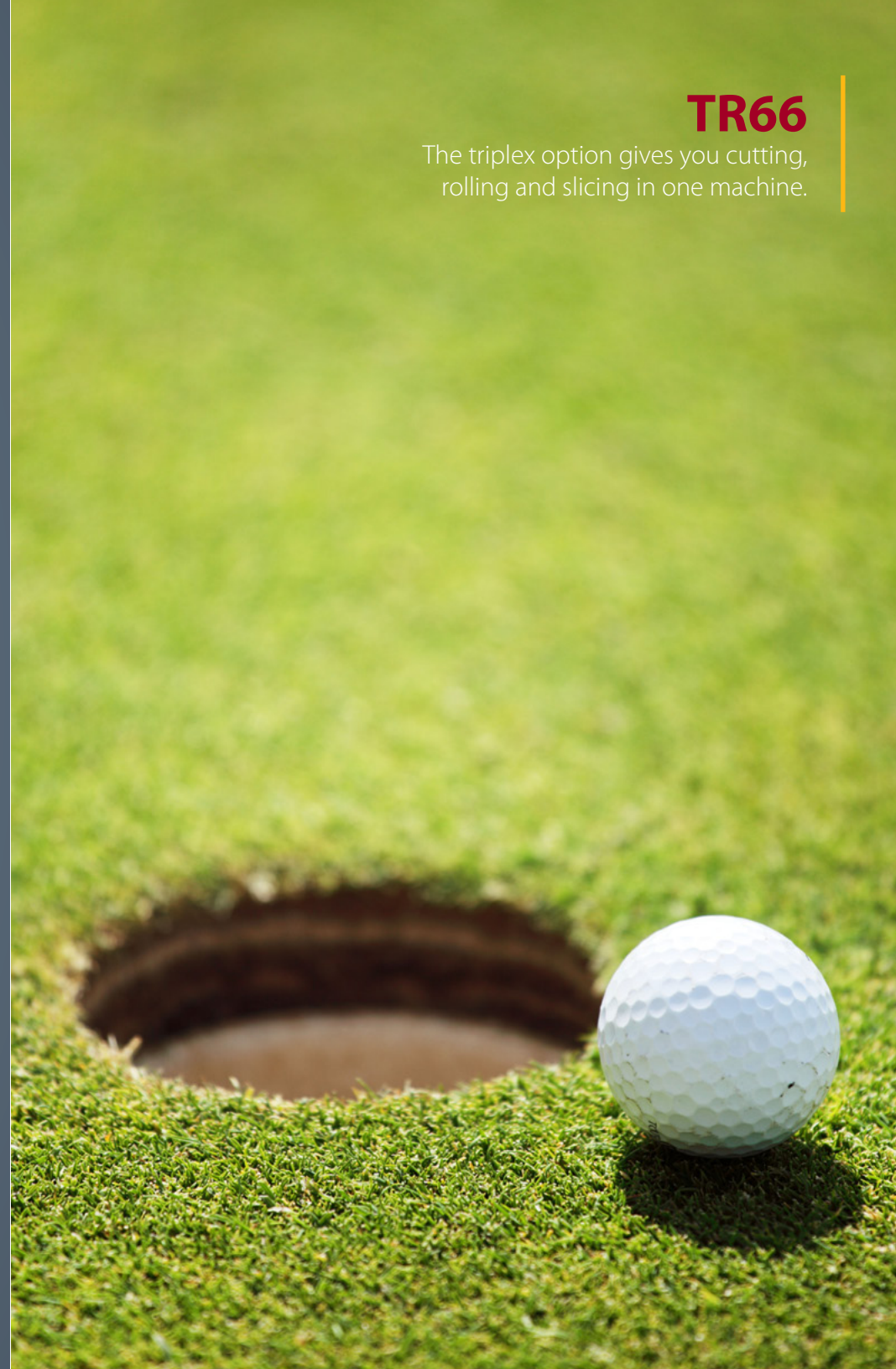

Optional Kits for Tru-Turf

Rollers



E7183

R52-11TC/R52-ELT Drawbar Extension Handle Kit.

Suits all R52-11TC/R52-ELT units & provides additional leverage when putting the trailer into its towing position.

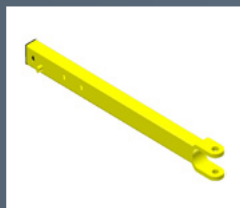

E7126

R52-11TC Drawbar - Straight.

Suits R52-11TC units. Available as a pin type or a 2" (50mm) ball coupling



E7188

R52-ELT/R52-11TC Drawbar Pin Hitch Coupling Assy C-W Jockey Wheel.

Suits all R52-ELT units. Also available as a pin type or a 2" (50mm) ball coupling



R8031

RS48-11 Brush Sweeper Kit.

This kit can be installed in place of the spiker/slicer arrangement.

To order, please provide the Serial No of your machine.

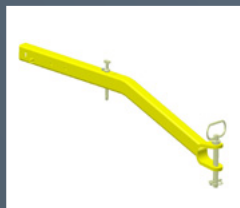

R8326

R52-11TC Swivel - Height Adjustable Drawbar.

The drawbar is height adjustable for easier match to tow vehicle hitch coupling.

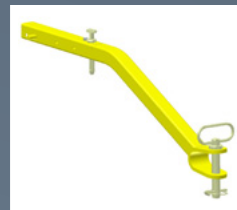

R8333

GR & RS Swivel - Height Adjustable Drawbar.

The drawbar is height adjustable for easier match to tow vehicle hitch coupling.



R8372

RS48 Series Porcupine Spiker kit - multiple hub & pin style.

This independent hub, replaceable pin style Spiker can be used while the unit is Rolling.

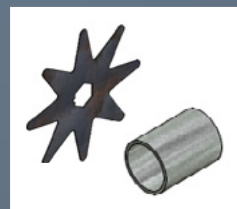

T3010B

TR66 Spiker/Slicer Update Kit.

This kit allows the original spiker assembly of 9 spiker blades to be increased to 13 blades.



R8378

Honda Engine - Engine Oil Drain Tray.

This part makes draining engine oil an easier, cleaner operation. Can be fitted to all Honda powered machines.

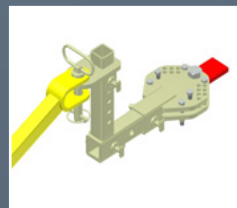

R9081

Adjustable Tow Hitch Assembly.

Allows most drawbars to change height up or down.

Use only with Tru-Turf green rollers. Max. towing capacity 700kg (1540lb). Not for open road or highway use.



TRU-TURF

www.truturf.com

Your local authorized dealer